



LED Modules for all signage applications

- Protection Class.....IP68
- Operating Temperature.....-22° ~ 158° F
- Life Rating.....>50,000 hours
- Fastening.....3M tape & mechanical

- .....Non-Polarized Wires
- .....Reverse Circuit Protection
- .....Wire-Thru Technology

3-LED Lens Color Modules



Interone LED Modules are covered by US Design Patent D861,922 S

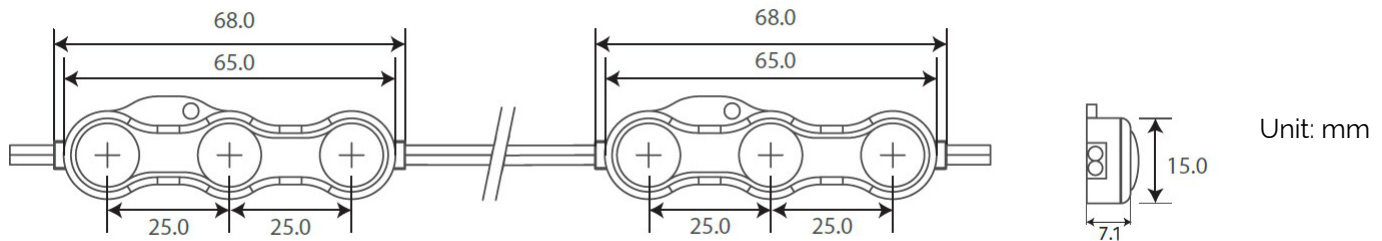

Group	Part Number	Color	Beam Angle	CCT (Kelvin)	Wave-length (nm)	Intensity		Current (mA)	Wattage	Wire length (in)	Module/ft
						Lm/W	Lm				
Lens 3-LED 0.72W Korean Chip	Z3V-05-R-a7-072-K2	Red	170°	NA	630	22	16	60	0.72	3.1	2
	Z3V-05-G-a7-072-K2	Green	170°	NA	520	67	48	60	0.72	3.1	2
	Z3V-05-B-a7-072-K2	Blue	170°	NA	460	14	10	60	0.72	3.1	2
	Z3V-05-Y-a7-072-K2	Yellow	170°	NA	585	24	17	60	0.72	3.1	2
	Z3V-05-T-a7-072-K2	Turq	170°	NA	485	20	14	60	0.72	3.1	2
	Z3V-05-P-a7-072-K2	Pink	170°	NA	NA	11	8	60	0.72	3.1	2

Power Supply Capacity (with 20% reserved power)

12 VDC Power Supply	0.24W per module	0.48W per module	0.72W per module	1.20W per module	1.44W per module	1.50W per module
60W	200 Modules	100 Modules	67 Modules	40 Modules	33 Modules	32 Modules
100W	333 Modules	167 Modules	111 Modules	67 Modules	56 Modules	53 Modules
150W	500 Modules	250 Modules	167 Modules	100 Modules	83 Modules	80 Modules
200W	667 Modules	333 Modules	222 Modules	133 Modules	111 Modules	107 Modules
300W	1000 Modules	500 Modules	333 Modules	200 Modules	167 Modules	160 Modules

Figure shown with 80% of rated power output. It is not recommended to exceed 80% of power capacity.

